

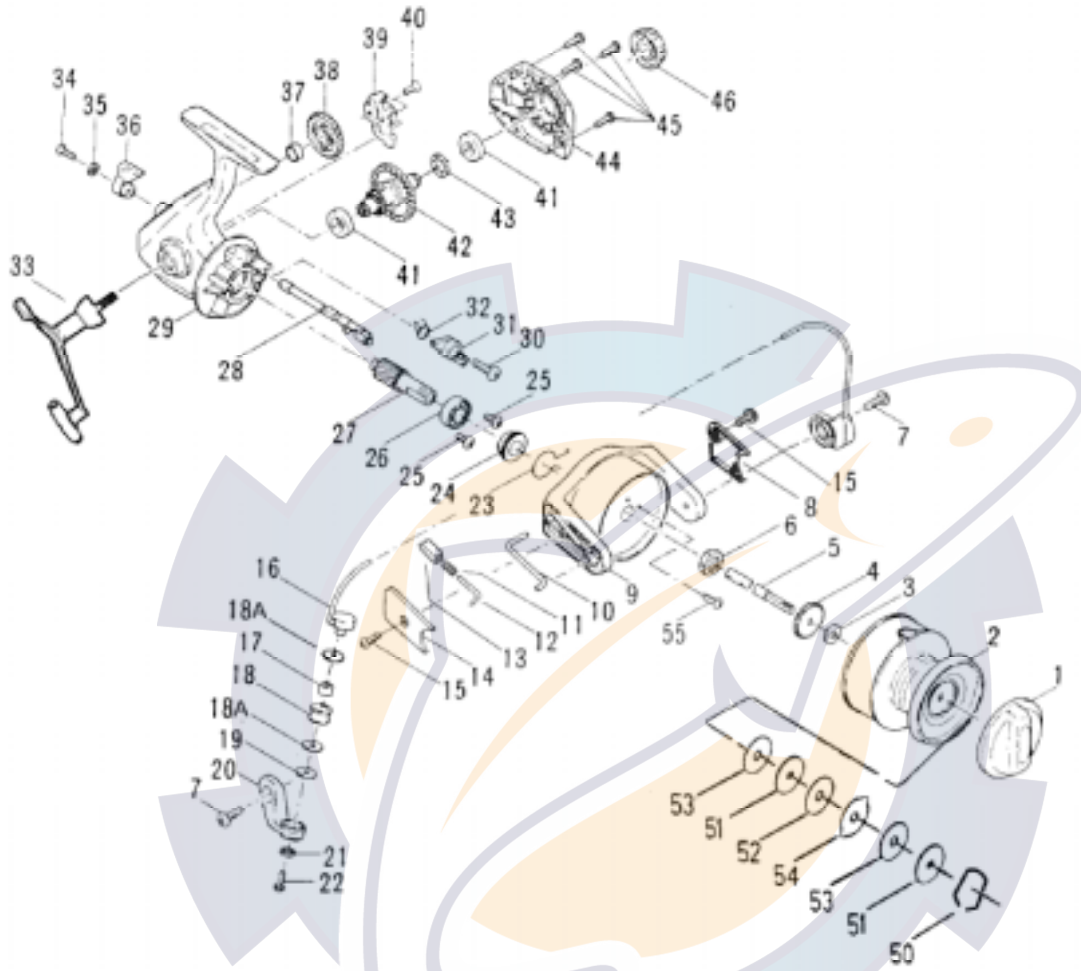

PARTS AND PRICE LIST FOR MODEL PG7000



| Key No. | Part No. | Description | Key No. | Part No. | Description |
|---------|-----------|------------------------------------|---------|-------------|-----------------------------------|
| 1 | 052 6000 | Drag Knob Asm. w/Spring | 28 | 006A3000 | Eccentric Shaft |
| 2 | 047 6000 | Spool Assembly | 29 | 001 6000P | Housing |
| 3 | 060 6000 | Thrust Washer | 30 | 003 6000 | Dog Mounting Screw |
| 4 | 040B6000 | Click Ratchet | 31 | 004 6000 | Anti-Reverse Dog |
| 5 | 039 6000 | Spool Shaft | 32 | 004A6000 | Dog Spring |
| 6 | 038 6000 | Rotor Nut | 33 | 015 6000P | Handle Assembly |
| 7 | 031A3000 | Arm Screws (2 req.) | 34 | 006F3000 | Eccentric Lever Mtg. Screw |
| 8 | 227 6000P | Cam Cover | 35 | 036A103 | Lock Washer |
| 9 | 027 6000P | Rotor Cup | 36 | 006E3000 | Eccentric Lever |
| 10 | 028A6000P | Cam Lever | 37 | 231A3000 | Crosswind Gear Bushing |
| 11 | 034C6000 | Pivot Spring | 38 | 231 6000 | Crosswind Gear |
| 12 | 034B6000P | Pivot Shaft | 39 | 043 6000 | Crosswind Gear Block |
| 13 | 034D6000P | Pivot Guide | 40 | 044 6000 | Crosswind Gear Block Screw |
| 14 | 027A6000P | Bail Pivot Cover | 41 | 002A6000 | Cover & Housing Bushings (2 req.) |
| 15 | 022 875 | Cover Screws (2 req.) | 42 | 008 6000P | Main Gear |
| 16 | 024 6000P | Bail Wire Assembly | 43 | 008A6000 | Main Gear Shim |
| 17 | 035A3000 | Line Roller Bushing | 44 | 045 6000P | Housing Cover |
| 18 | 035 6000 | Line Roller | 45 | 046 6000 | Cover Screws (4 req.) |
| 18A | 035B1000P | Line Roller Teflon Washer (2 req.) | 46 | 233 3000 | Bearing Cover |
| 19 | 132 3000 | Line Roller Washer | 47 | **048 1000P | Spool Click Tongue |
| 20 | 034 6000P | Bail Arm | 48 | **049 103CS | Click Tongue Screw |
| 21 | 036A103 | Lock Washer | 48A | **022 103CS | Click Tongue Spring |
| 22 | 036 1000 | Bail Stud Screw | 50 | 051 6000 | Drag Retaining Ring |
| 23 | 230 6000 | Silent Dog Spring | 51 | 057 6000 | Keyed Drag Washers (3 req.) |
| 24 | 019A6000 | Pinion Spacer | 52 | 006 6000 | Teflon Drag Washers (3 req.) |
| 25 | 022 875 | Bearing Mtg. Screw (2 req.) | 53 | 006 7000 | Drag Washer HT-100 (2 req.) |
| 26 | 020 6000 | Ball Bearing | 54 | 058 3000 | Ear Drag Washers (1 req.) |
| 27 | 019 6000 | Pinion Gear | 55 | 305 875 | Rotor Nut Locking Screw |

**Not Shown